

Self Adhesive Wallpaper



INSTALLATION INSTRUCTIONS

What is self-adhesive wallpaper?

Self-adhesive wallpaper is a novel style of wall décor that has a self-adhesive backing. It does not require any additional glue or wallpapering paste to attach to a surface, unlike traditional wallpaper. This makes installation easier because no expert assistance or complicated procedures are required.

What should I think about before purchasing self-adhesive wallpaper?

Begin by carefully measuring the wall you intend to cover with self-adhesive wallpaper to ensure you buy enough. Always buy a little extra wallpaper than you think you'll need to account for mistakes and cutoffs. To ensure color consistency, ensure that all rolls you order are from the same batch.

What tools will I require to install self-adhesive wallpaper?

In contrast to traditional wallpaper, self-adhesive wallpaper variants require extremely few tools to apply. Before you begin, ensure that you have the following items on hand:

- Tape measure
- Spirit level
- Pencil
- Plastic smoothing tool
- Metal ruler (alternatively a straight edge)
- Cutter knife



Is it necessary to prep the wall before applying peelable wallpaper?

A clean, non-greasy, dry, and flat surface is required for self-adhesive wallpaper. For the greatest results, we recommend priming the wall to provide an equal surface. Choose superior satin or semi-gloss paint and let it dry completely. Remember that new paint can take up to four weeks to heal. Do

not rush through this step since damp paint will prevent the removable wallpaper from sticking to the wall.

Is it necessary to clean the wall before applying self-adhesive wallpaper?

Even if the surface is smooth and does not require priming, it is a good idea to spend a few minutes cleaning it before beginning the installation procedure. Simply use a moist sponge and a moderate, non-abrasive solution to clean the wall surface. Allow the surface to thoroughly dry overnight.

Which procedures should you take to install my self-adhesive wallpaper?

To ensure a great outcome for your self-adhesive wallpaper décor job, we recommend carefully following the directions below:

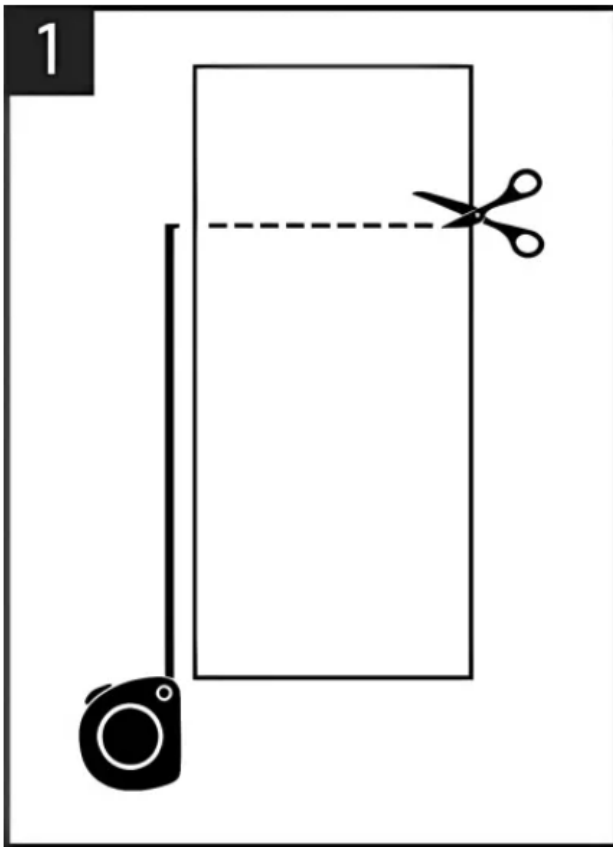

1. Strips clipped to size

Begin by cutting self-adhesive wallpaper strips to wall height, leaving a few centimeters on each end for trimming. To assist maintain a smooth, clean cut, use a sharp cutter knife and change the blade frequently. If the wallpaper contains a pattern, make sure to align the design from strip to strip before cutting. To keep your design in the correct order, number the back of each length of wallpaper.

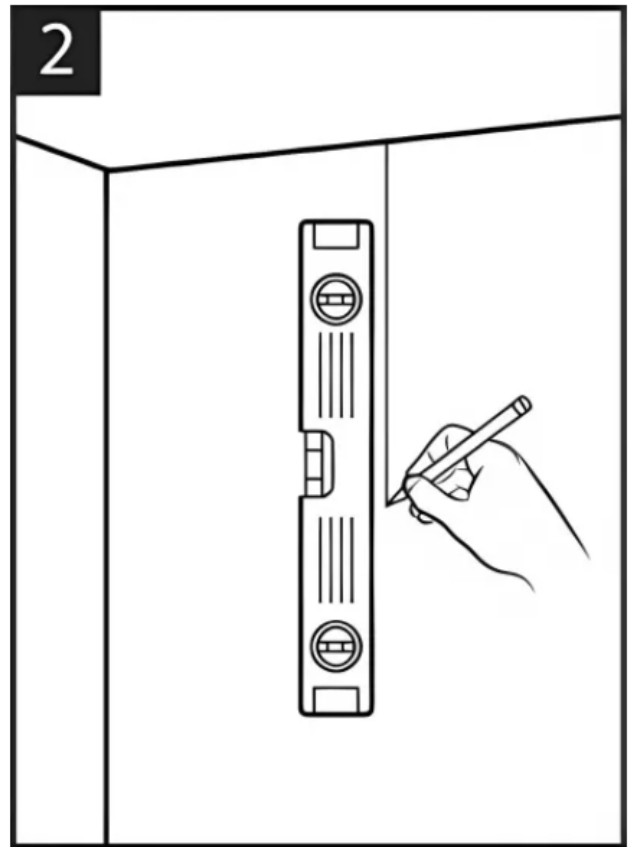

2. Mark the first strip on the wall

Installing the first strip correctly is critical since it serves as the foundation for all subsequent strips, so take your time. Begin on the wall's left side. Starting from the corner, measure the width of the paper and make a light pencil mark on the wall. Draw a straight line down with your level. For your first length of wallpaper, use this line as a guide.

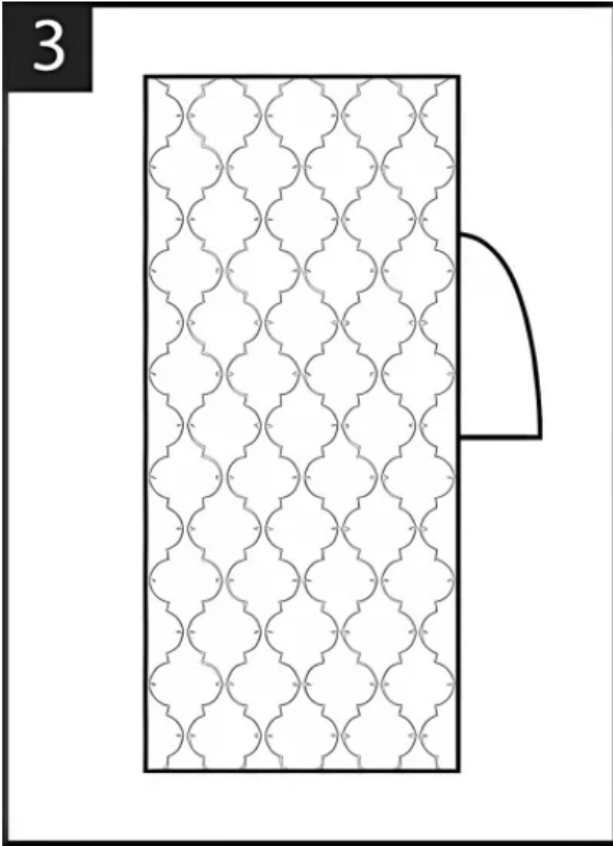

3. Begin by hanging the first strip

Peel 30 to 60 cm of the backing away from the wallpaper with the first strip. Apply the paper to the top of the wall, allowing for some overlap that will be clipped away from the ceiling later. Make sure the right side of the strip is aligned with your mark and lightly press the edge to the wall along the mark. You must create a vertical seam. Remember that you may always move the strip if necessary.

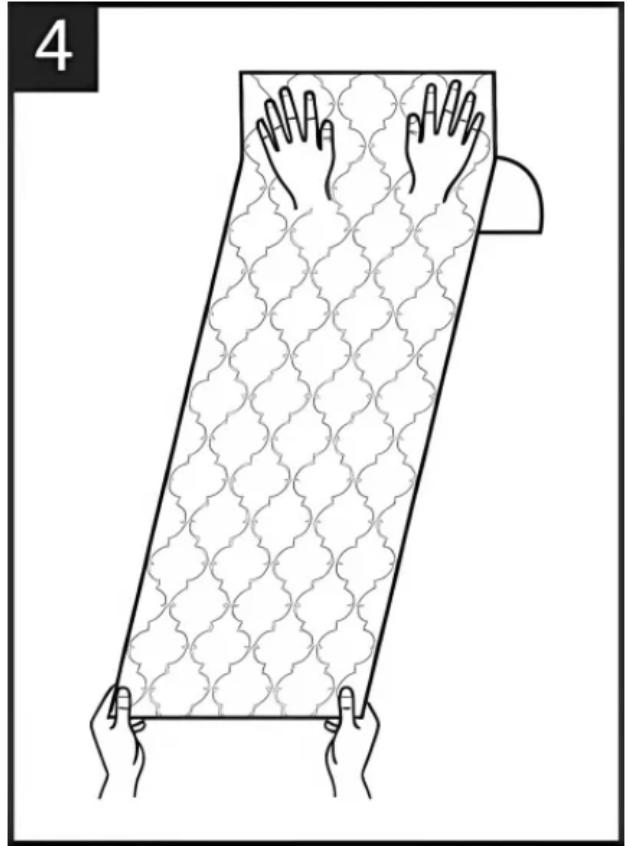

4. Begin at the top and work your way down

Pull the backing away from the paper as you evenly press it to the wall a few cm at a time, working from top to bottom. Be careful not to pull too hard, as the design will not line if the material expands. It's ideal to do this with someone else, with one directing the paper at the top and down the seam and the other holding the opposite edge away from the wall until the seams match up.

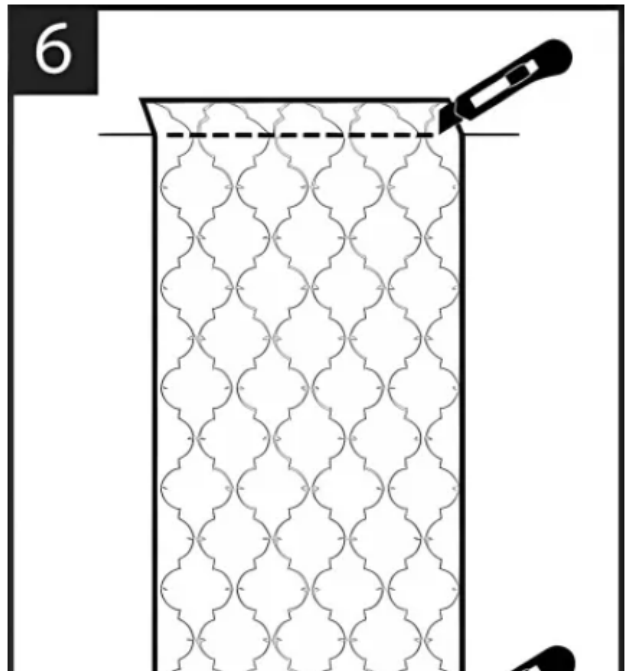
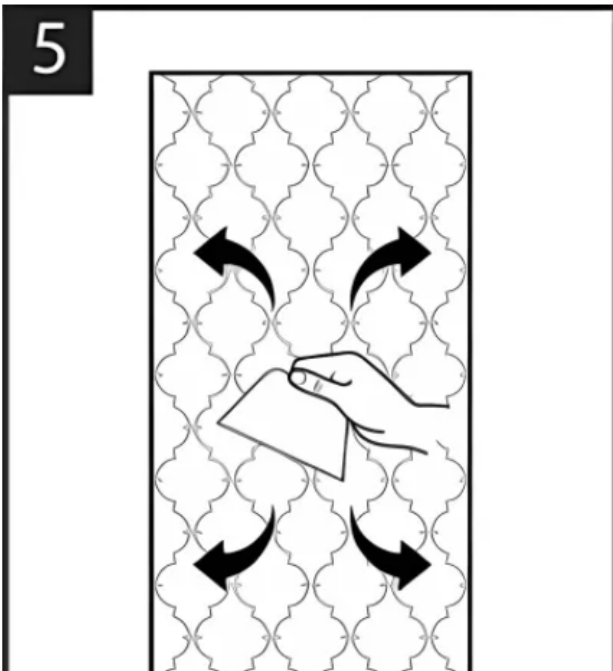

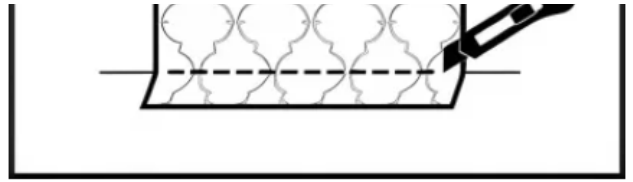
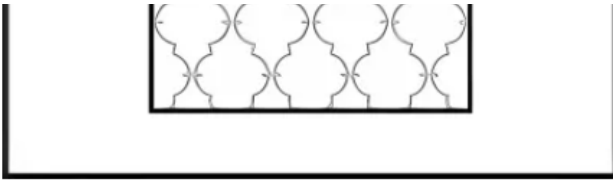

5. Make the surface smooth

Work your way down the strip in a back-and-forth motion with a firm smoothing tool, smoothing the material to the wall to activate the adhesive already present on the coating and to press out any air bubbles (move them from the Centre to the outside of the strip). Apply consistent and forceful pressure to ensure that any air bubbles are gone and the wallpaper clings to the wall securely.

6. Trim the excess and continue with the next strip

Trim any surplus material at the ceiling and floor level with a straight edge and a sharp cutting knife. Repeat the preceding technique, matching your next strip to the right edge of the previous strip.

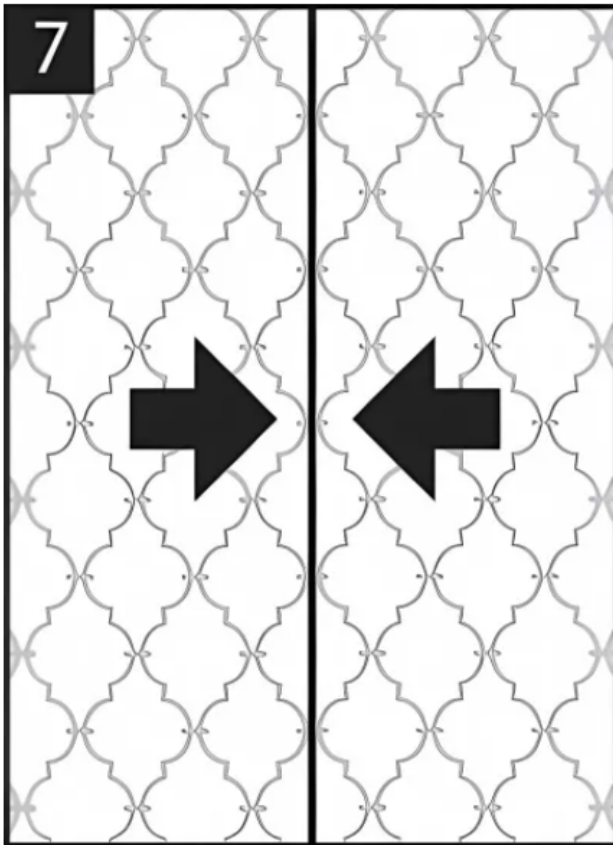

7. When necessary, overlap patterns

To achieve the best effects with some patterns, it may be necessary to overlap each strip by a few millimeters. The overlap should not exceed 0.15 cm. In these circumstances, pay close attention to ensure that the pattern is exactly aligned.

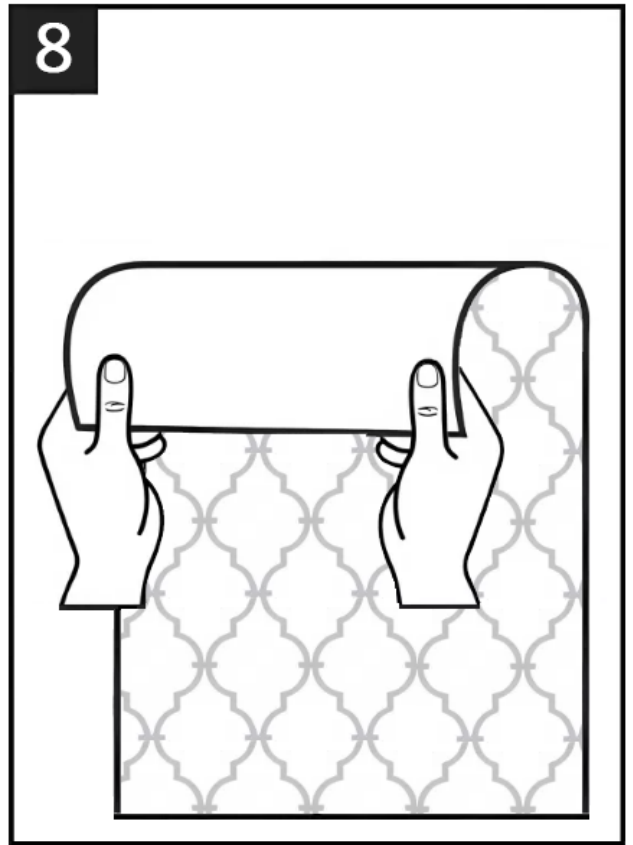

8. Suggestions and tricks

- Be patient, as this is essential when installing self-adhesive wallpaper.
- When wallpapering all of the walls, take a peek around the room to choose the most visible location. Start from the left corner in that prominent area, as this is where you want your wallpaper to look at its finest.
- If bubbles reappear, smooth them out with hard pressure using a smoothing instrument.

What is the lifespan of peelable wallpaper on the walls?

The longevity of self-adhesive wallpaper is determined by the overall quality of the product as well as the surface on which it is installed. A high-quality self-adhesive wall décor made of non-woven material can stay if you want it to, if the surface you put it on is clean, smooth, and has been treated with the appropriate paint finish.

Is self-adhesive wallpaper suitable for every type of wall?

Most surfaces, including furniture, can benefit from the use of high-quality self-adhesive wallpaper. Self-adhesive wallpaper, on the other hand, requires a surface on which it can successfully cling. This means that if you intend to apply it on a rougher surfaced wall, it may not adhere correctly, reducing its longevity.

Is it possible to decorate furniture using self-adhesive wallpaper?

The application of self-adhesive wallpaper is not limited to walls. It is also a fantastic choice of furniture, giving old pieces fresh vitality. Self-adhesive wallpaper can be used to design any part of a piece of furniture, such as the front, sides, top, or only the insides of drawers, giving you a wealth of creative possibilities.

Is aligning self-adhesive wallpaper patterns difficult?

Each length of wallpaper can be removed and reattached until you are satisfied with the outcome and alignment. Remember that the more detailed the pattern, the more difficult the installation process. If you prefer an easier chore, choose a self-adhesive wallpaper with a simpler, bigger pattern, or perhaps a textured, monochrome variant.

Can I put self-adhesive wallpaper on top of regular wallpaper?

You can put self-adhesive wallpaper over existing conventional wall décor if the surface is flat and the existing wallpaper sticks to the wall completely without bubbles or spots where it is starting to peel off. If you opt to install traditional wall décor and then cover it with self-adhesive wallpaper, wait at least four weeks to ensure the initial layer is completely dry.

How can I clean wallpaper that adheres to itself?

All of the self-adhesive wallpapers we sell are machine washable. If you need to remove a little spot, use a mild detergent and a damp sponge or towel. Check the sponge beforehand and avoid anything too abrasive that could scratch the wallpaper surface. Begin by combining the detergent and water and applying the solution to the wallpaper. Spread it softly and evenly across the surface with a sponge, then wipe it away with a soft damp towel. Wipe the surface with a clean, dry towel.

Can self-adhesive wallpaper be applied in bathrooms or kitchens?

Bathrooms and kitchens can benefit from our self-adhesive wallpaper. To guarantee the best possible adhesion, the surface beneath should be prepared with care. Before commencing the installation process, ensure that the bathroom is completely dry and well-ventilated. To minimize excessive humidity build-up, we recommend opening the windows and airing out the room after a bath or a long shower.